

3D VIEW  
SCALE: 1:100

MATERIALS DESCRIPTION

0 Material and Finish information is found on the next pages

ALL FINISH OF EVERY MATERIAL IS TO BE  
ACCORDING TO SAMPLE

ALL SHARP EDGES TO BE ROUNDED OF

Rev.	Date	Drawn	Check	Description

Project: Lunteren							
Article No.: -							
Article Name: -							
Reference No.: -			PRELIMINARY				
Variations on dimensions without tolerance values are according ISO 2768 mK		Units:	mm	Drawn:	ATB	Size:	A3
		Scale:	1:00	Date:	27-05-2014	Sheet:	1/8

This drawing remains our property and must be returned immediately at our request.  
It is prohibited to distribute or show this drawing to any third party or company.  
This drawing is copyrighted and any unauthorized use, distribution, reproduction or modification is illegal and must be compensated

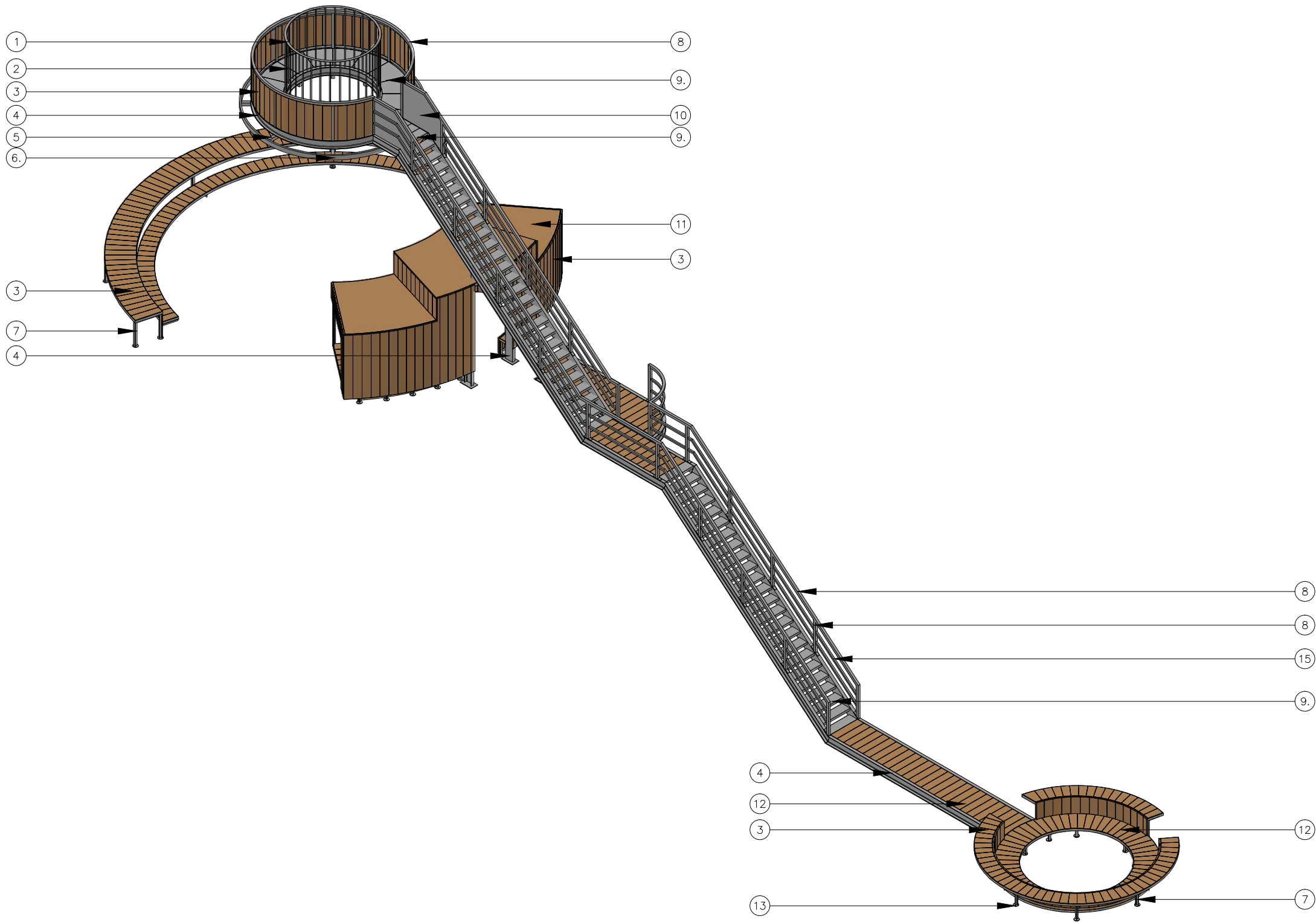

3D VIEW  
SCALE: 1:100

MATERIALS DESCRIPTION

1	Material: 104meter 60x6mm wg staal strip Finish: verzinkt
2	Material: 48meter Ø21.3x2mm 1/2 inch stalen buis Finish: verzinkt
3	Material: 175meter 200x32mm watervast hardhout Finish: onbehandeld
4	Material: 73meter 220x80 UNP Finish: verzinkt
5	Material: 8meter 80x80x3mm stalen koker Finish: verzinkt
6	Material: 12meter 120x40x3 stalen koker Finish: verzinkt
7	Material: 229meter 60x60x7mm T profiel Finish: verzinkt
8	Material: 69meter 60x60x3mm stalen koker Finish: verzinkt
9	Material: 17M2 gripprofiel staal plaat Finish: verzinkt
10	Material: 2.4M2 6mm dik staal plaat Finish: verzinkt
11	Material: 11M2 32mm dik watervast multiplex Finish: behandeld met een watervaste primer voor het gras vlak
12	Material: 88meter 200x40mm watervast hardhout Finish: onbehandeld
13	Material: 34x Ø120x6 schijf staal Finish: verzinkt
14	Material: 4meter 60x60x6mm hoekstrip wg staal Finish: verzinkt
15	Material: 66meter 40x40x2mm stalen koker Finish: verzinkt

ALL FINISH OF EVERY MATERIAL IS TO BE  
ACCORDING TO SAMPLE

ALL SHARP EDGES TO BE ROUNDED OF

Rev.	Date	Drawn	Check	Description

Project:	Lunteren			
Article No.:	-			
Article Name:	-			
Reference No.:	-			
		PRELIMINARY		

Variations on dimensions without tolerance values are according ISO 2768 mK		Units: mm	Drawn: ATB	Size: A3
Scale: 1:100	Date: 27-05-2014	Sheet: 2/8		

This drawing remains our property and must be returned immediately at our request.  
It is prohibited to distribute or show this drawing to any third party or company.  
This drawing is copyrighted and any unauthorized use, distribution, reproduction or modification is illegal and must be compensated

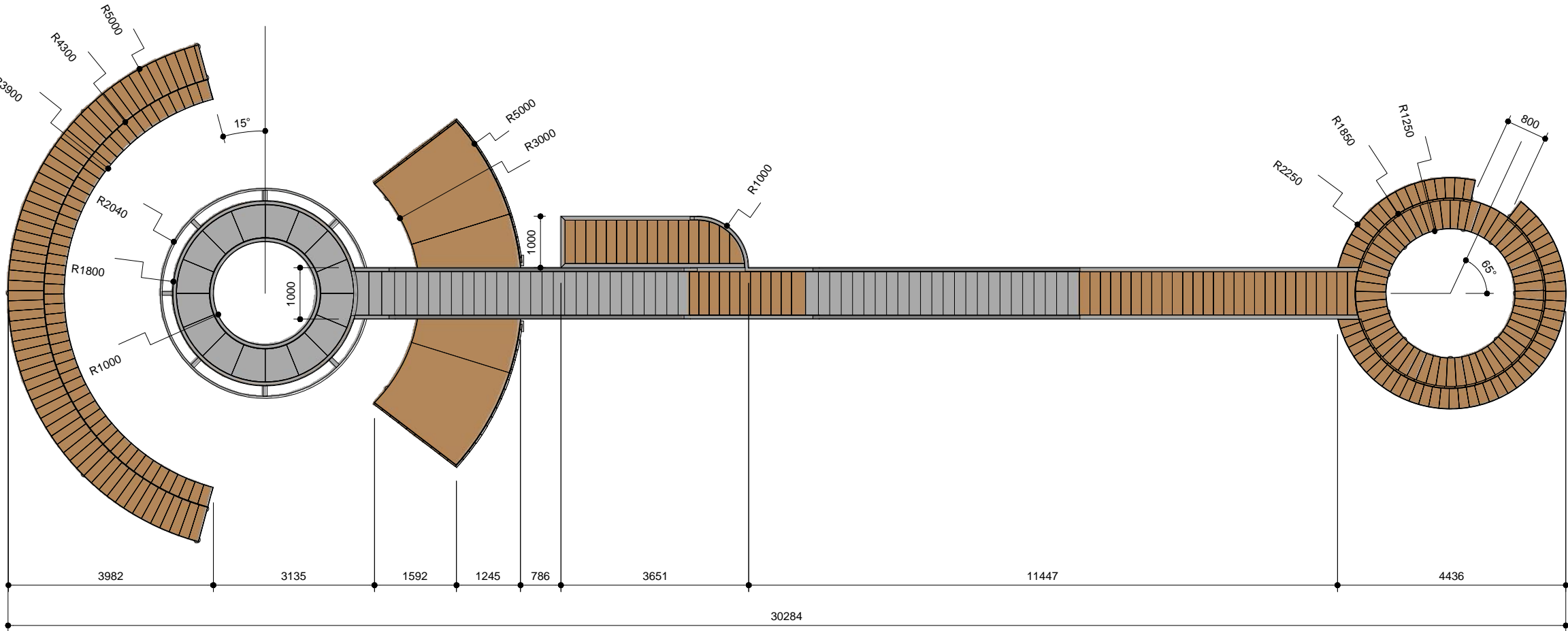

TOP VIEW  
SCALE: 1:100

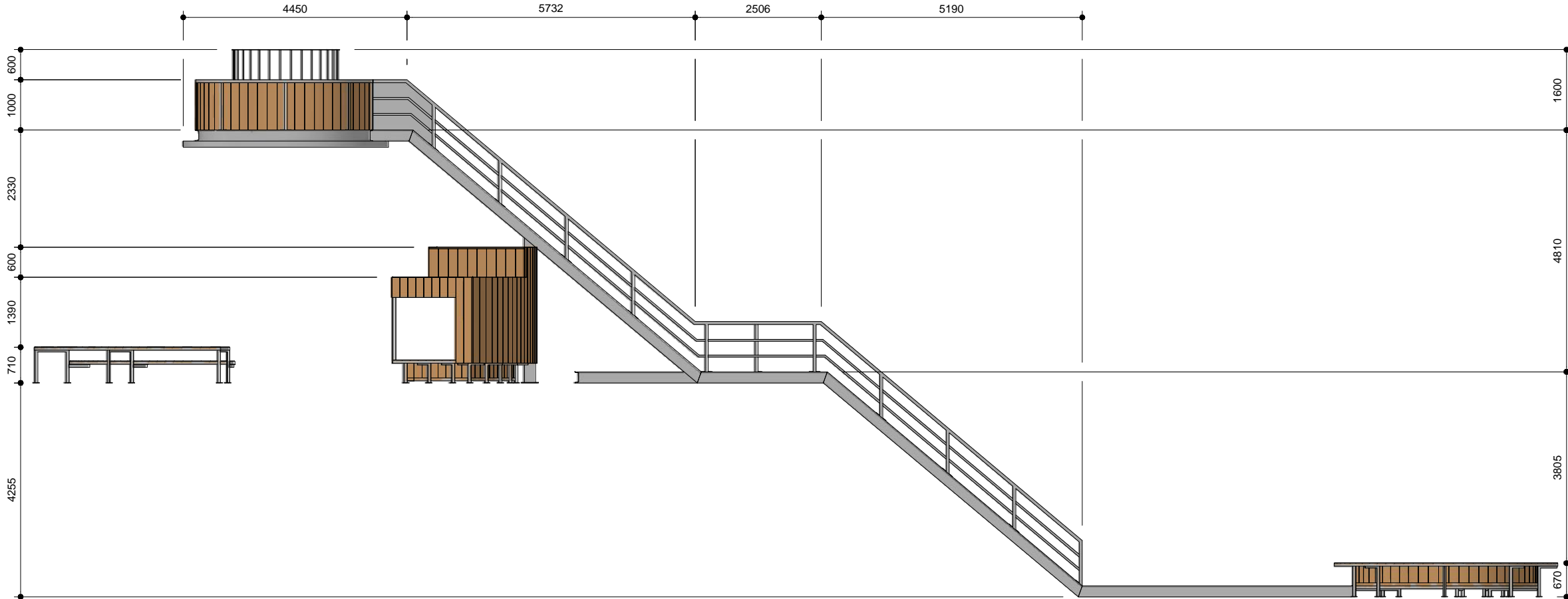

FRONT VIEW  
SCALE: 1:100

MATERIALS DESCRIPTION

1 Name:  
-

ALL FINISH OF EVERY MATERIAL IS TO BE  
ACCORDING TO SAMPLE

ALL SHARP EDGES TO BE ROUNDED OF

Rev.	Date	Drawn	Check	Description

Project: Lunteren	
Article No.: -	
Article Name: -	
Reference No.: -	
PRELIMINARY	

Variations on dimensions without tolerance values are according ISO 2768 mK		Units:	mm	Drawn:	ATB	Size:	A3
		Scale:	1:100	Date:	27-05-2014	Sheet:	3/8

This drawing remains our property and must be returned immediately at our request.  
It is prohibited to distribute or show this drawing to any third party or company.  
This drawing is copyrighted and any unauthorized use, distribution, reproduction or modification is illegal and must be compensated

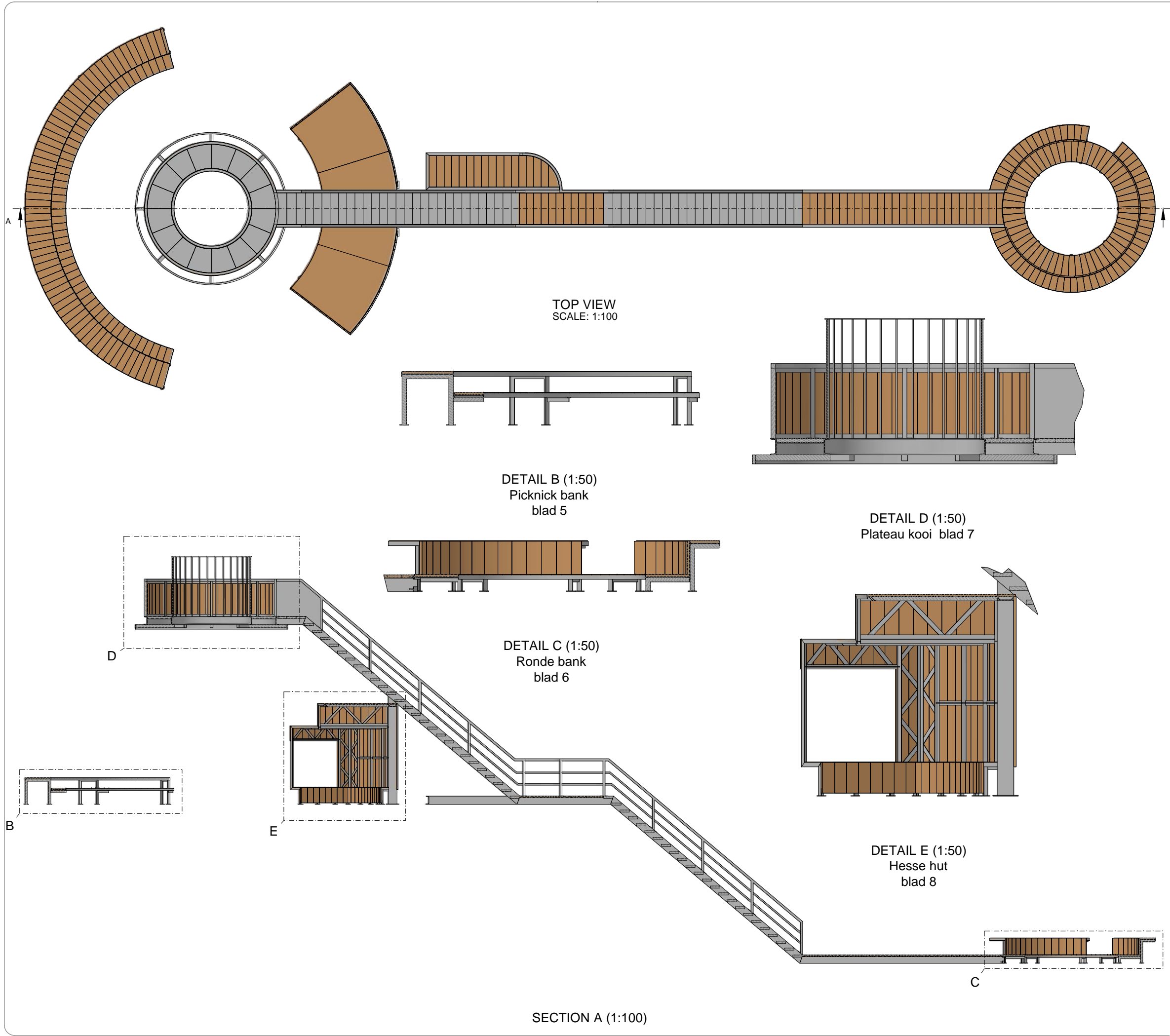

MATERIALS DESCRIPTION

1

Material:  
Finish:

ALL FINISH OF EVERY MATERIAL IS TO BE  
ACCORDING TO SAMPLE

ALL SHARP EDGES TO BE ROUNDED OF

Rev.	Date	Drawn	Check	Description

Project:  
Lunteren

Article No.:  
-

Article Name:  
-

Reference No.:  
-

PRELIMINARY

Variations on dimensions without tolerance values are according ISO 2768 mK		Units: mm	Drawn: ATB	Size: A3
		Scale: 1:100	Date: 27-05-2014	Sheet: 4/8

This drawing remains our property and must be returned immediately at our request.  
It is prohibited to distribute or show this drawing to any third party or company.  
This drawing is copyrighted and any unauthorized use, distribution, reproduction or modification is illegal and must be compensated

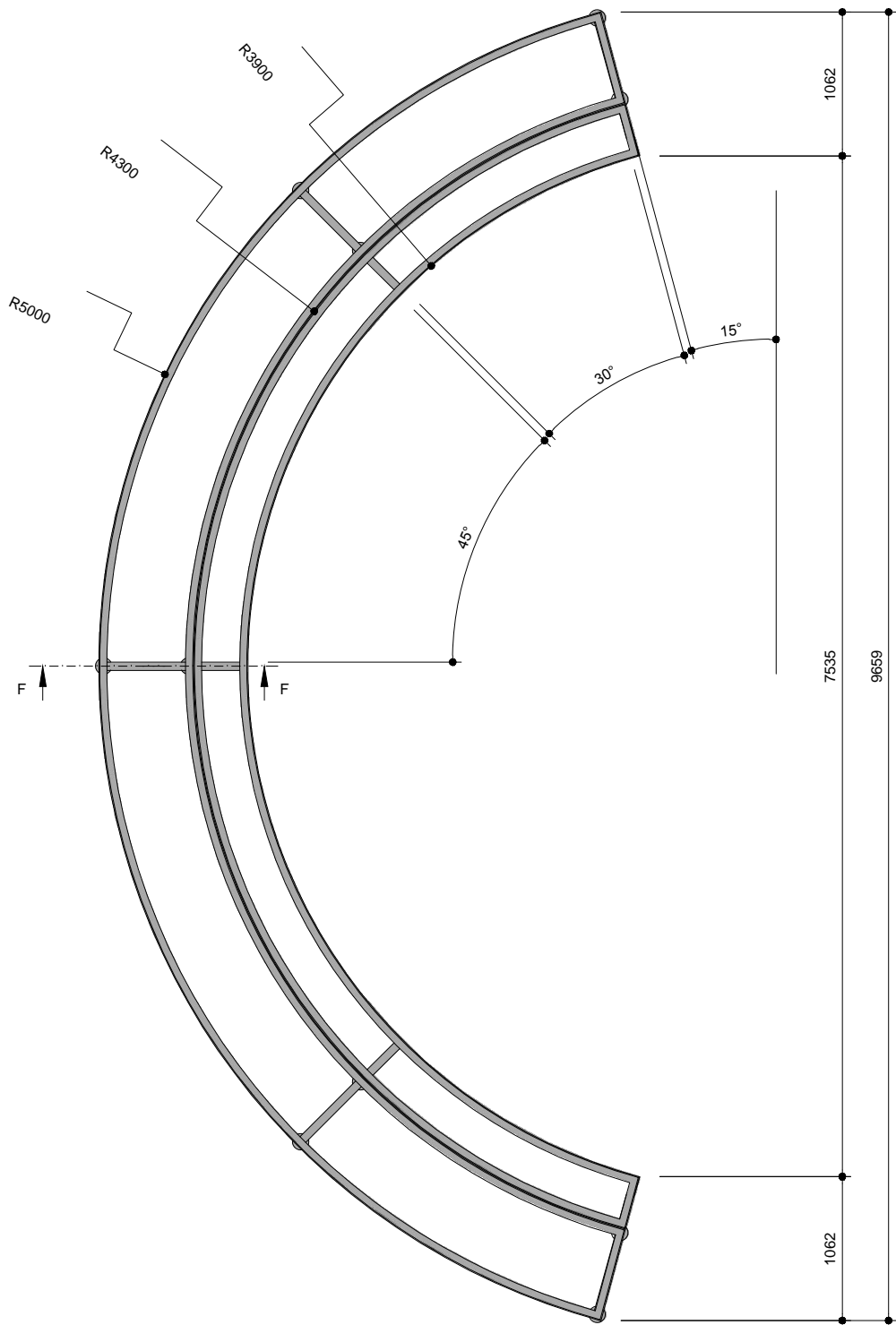

TOP VIEW  
SCALE: 1:50

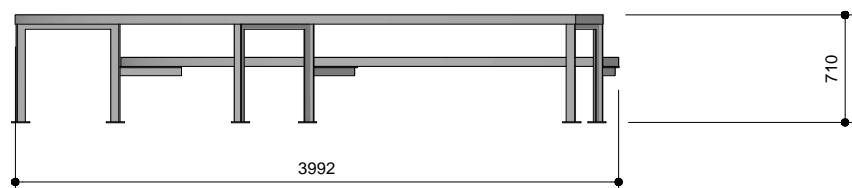

FRONT VIEW  
SCALE: 1:50

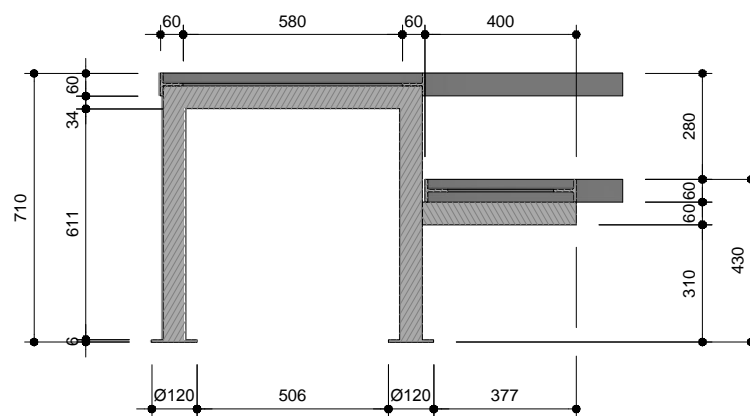
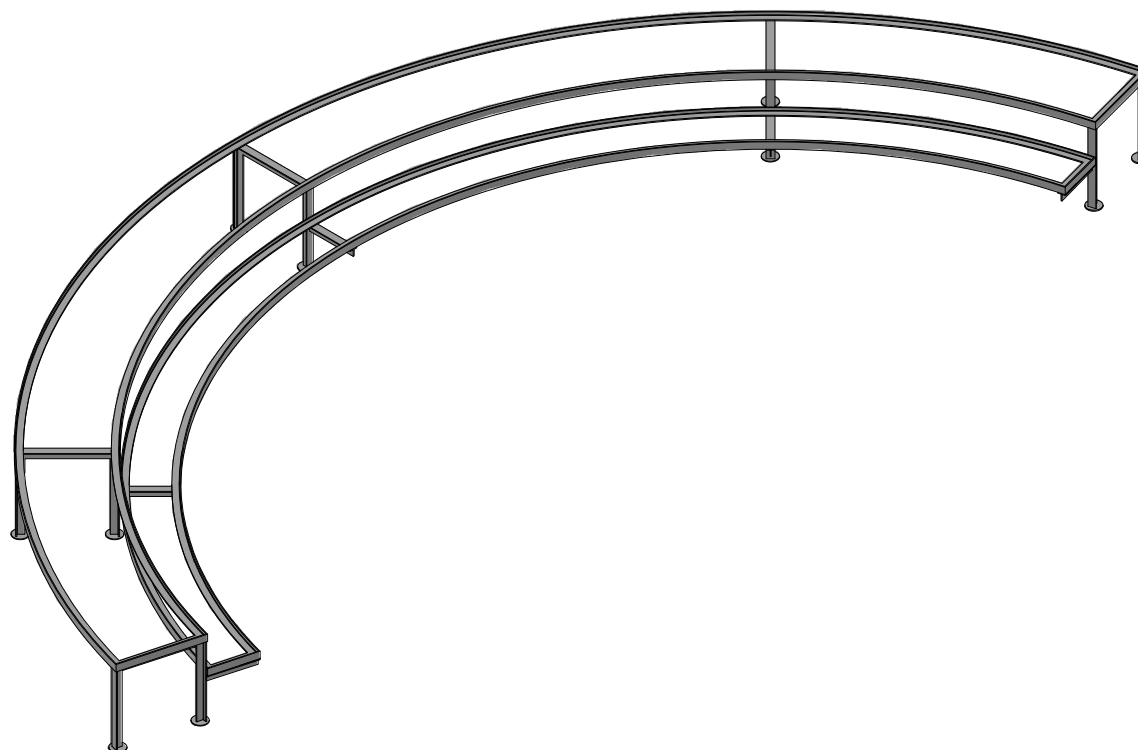

SECTION F (1:20)

## MATERIALS DESCRIPTION

1 Material:  
Finish:

ALL FINISH OF EVERY MATERIAL IS TO BE  
ACCORDING TO SAMPLE

ALL SHARP EDGES TO BE ROUNDED OF

Rev.	Date	Drawn	Check	Description

Project: Lunteren	
Article No.: -	
Article Name: -	
Reference No.: -	
PRELIMINARY	

Variations on dimensions without tolerance values are according ISO 2768 mK		Units: mm	Drawn: ATB	Size: A3
		Scale: 1:50	Date: 27-05-2014	Sheet: 5/8

This drawing remains our property and must be returned immediately at our request.  
It is prohibited to distribute or show this drawing to any third party or company.  
This drawing is copyrighted and any unauthorized use, distribution, reproduction or modification is illegal and must be compensated

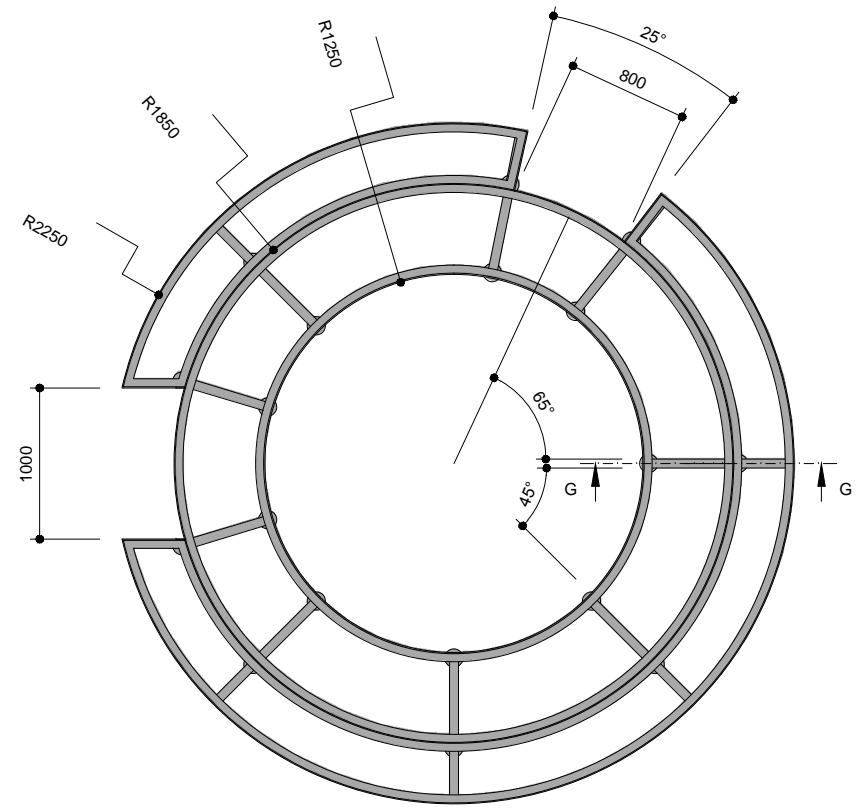

TOP VIEW  
SCALE: 1:50

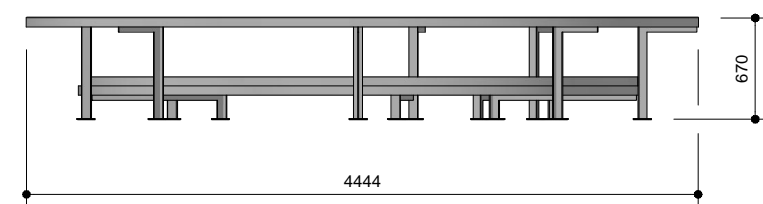

FRONT VIEW  
SCALE: 1:50

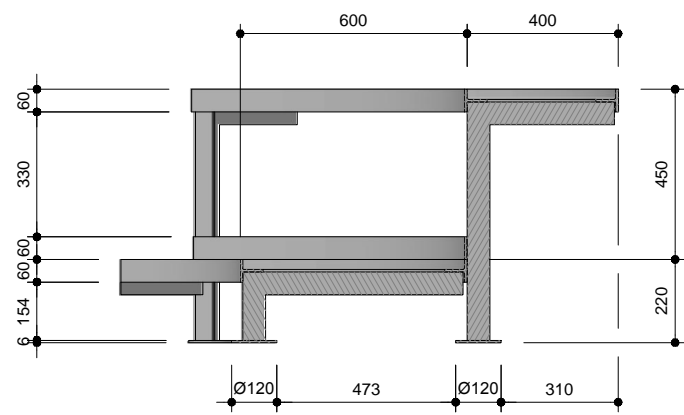
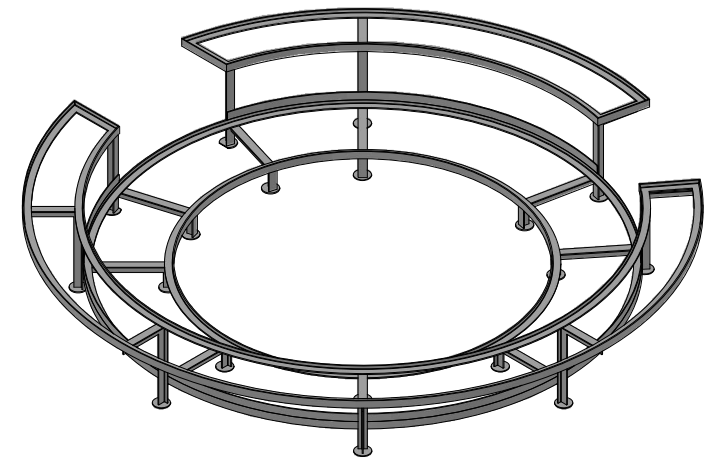

SECTION G (1:20)

MATERIALS DESCRIPTION

1

Material:  
Finish:

ALL FINISH OF EVERY MATERIAL IS TO BE ACCORDING TO SAMPLE

ALL SHARP EDGES TO BE ROUNDED OF

Rev.	Date	Drawn	Check	Description

Project:  
Lunteren

Article No.:  
-

Article Name:  
-

Reference No.:  
-

PRELIMINARY

Variations on dimensions without tolerance values are according ISO 2768 mK

Units: mm

Scale: 1:50

Drawn: ATB

Date: 27-05-2014

Size: A3

Sheet: 6/8

This drawing remains our property and must be returned immediately at our request.

It is prohibited to distribute or show this drawing to any third party or company.

This drawing is copyrighted and any unauthorized use, distribution, reproduction or modification is illegal and must be compensated



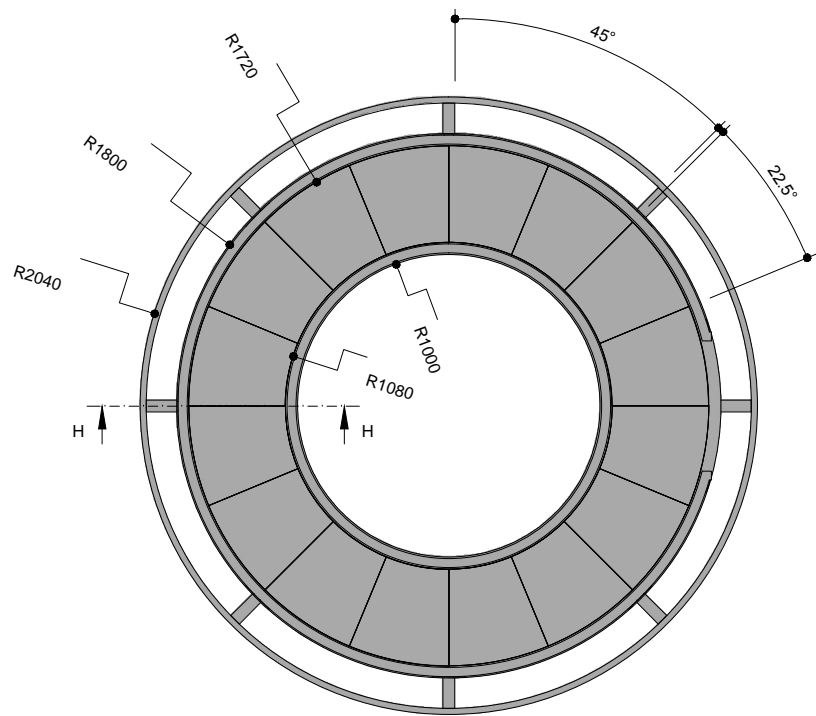

TOP VIEW  
SCALE: 1:50

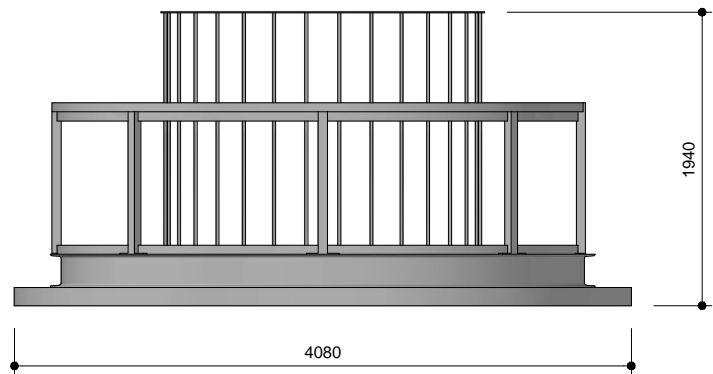

FRONT VIEW  
SCALE: 1:50

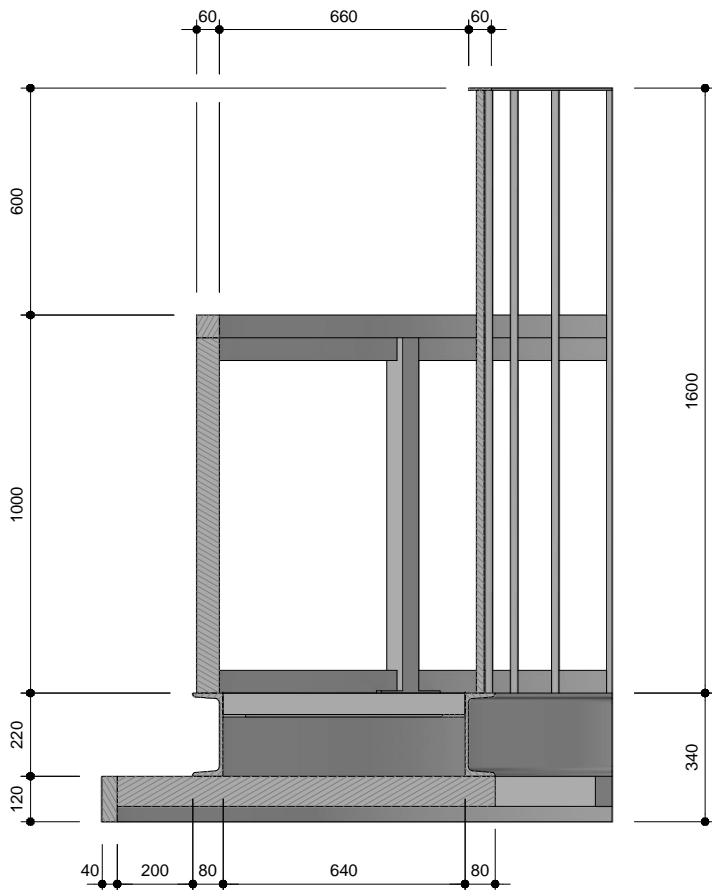
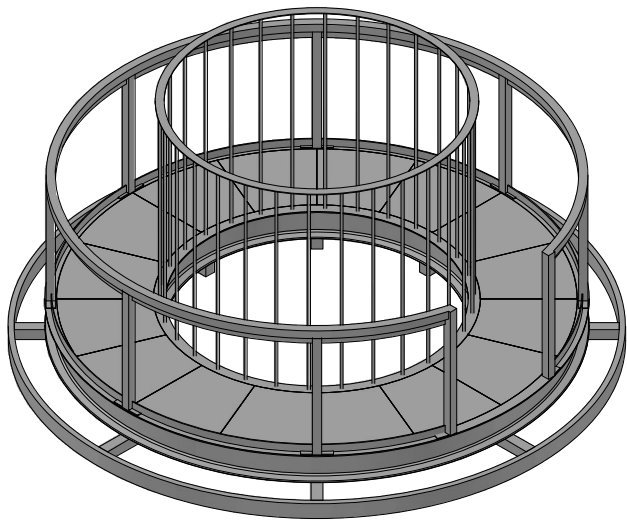

SECTION H (1:20)

MATERIALS DESCRIPTION

1 Material:  
Finish:

ALL FINISH OF EVERY MATERIAL IS TO BE  
ACCORDING TO SAMPLE

ALL SHARP EDGES TO BE ROUNDED OF

Rev.	Date	Drawn	Check	Description

Project:  
Lunteren

Article No.:  
-

Article Name:  
-

Reference No.:  
-

PRELIMINARY

Variations on  
dimensions without  
tolerance values are  
according ISO 2768 mK

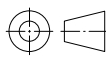

Units:	mm	Drawn:	ATB	Size:	A3
Scale:	1:50	Date:	27-05-2014	Sheet:	7/8

This drawing remains our property and must be returned immediately at our request.  
It is prohibited to distribute or show this drawing to any third party or company.  
This drawing is copyrighted and any unauthorized use, distribution, reproduction or modification is illegal and must be compensated

MATERIALS DESCRIPTION

1 Material:  
Finish:

ALL FINISH OF EVERY MATERIAL IS TO BE  
ACCORDING TO SAMPLE

ALL SHARP EDGES TO BE ROUNDED OF

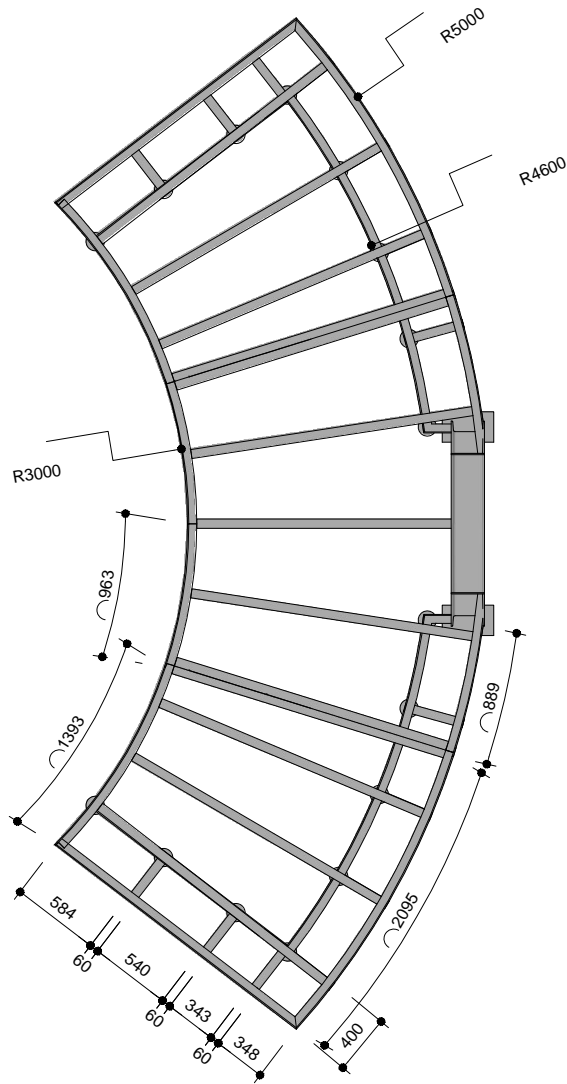

TOP VIEW  
SCALE: 1:50

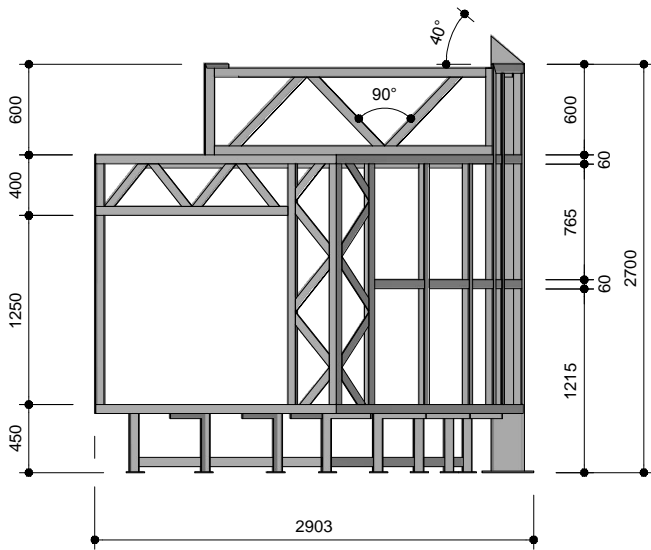

FRONT VIEW  
SCALE: 1:50

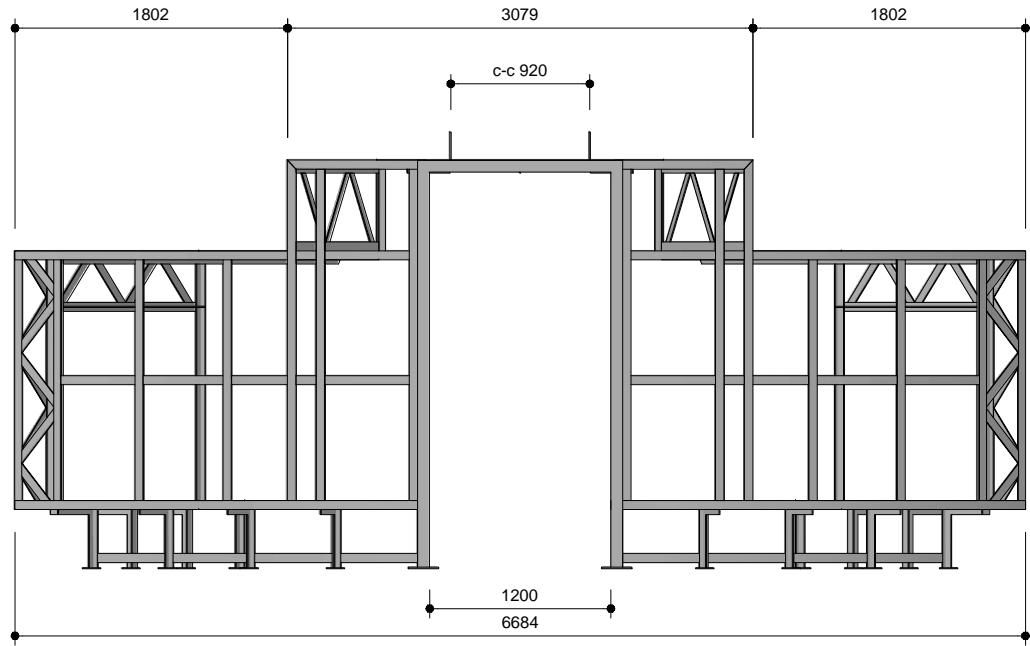
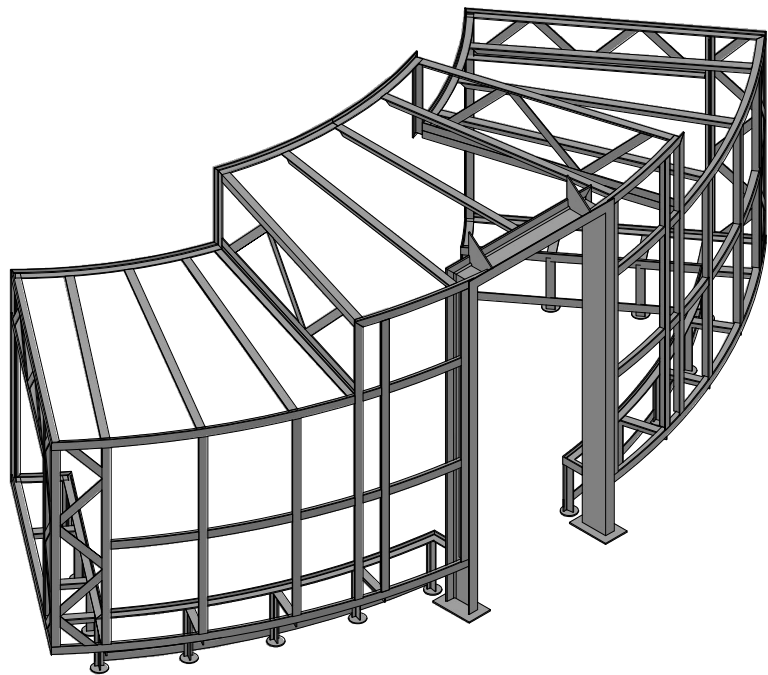

SIDE VIEW  
SCALE: 1:50

Rev.	Date	Drawn	Check	Description

Project:  
Lunteren

Article No.:  
-

Article Name:  
-

Reference No.:  
-

PRELIMINARY

Variations on  
dimensions without  
tolerance values are  
according ISO 2768 mK

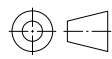

Units:	mm	Drawn:	ATB	Size:	A3
Scale:	1:50	Date:	27-05-2014	Sheet:	8/8

This drawing remains our property and must be returned immediately at our request.  
It is prohibited to distribute or show this drawing to any third party or company.  
This drawing is copyrighted and any unauthorized use, distribution, reproduction or modification is illegal and must be compensated